



33 Pile Way, Somersby, NSW

Proposed Resource Recovery Facility- 99,000
tonnes p/a

Project Overview

- Proposed resource recovery facility in existing approved industrial building, nearing completion- Zoned IN1
- Proposed 99,000 tonnes of non-putrescible waste material
- Proposed to operate 24/7
- Create 30 new jobs
- Capital investment value of \$2,878,000



Aims of proposal

- Increase recycling capabilities on the Central Coast to reduce waste going to landfill and keep materials in the useful economy for longer. The facility will help achieve NSW waste reduction targets.
- Help facilitate a circular economy by the recovery of materials that can be re-used in the production of particle board and MDF, among other uses.
- Provide employment opportunities to the local community
- Provide a facility that has minimal impacts on the environment and surrounding land uses



Proposed Plan

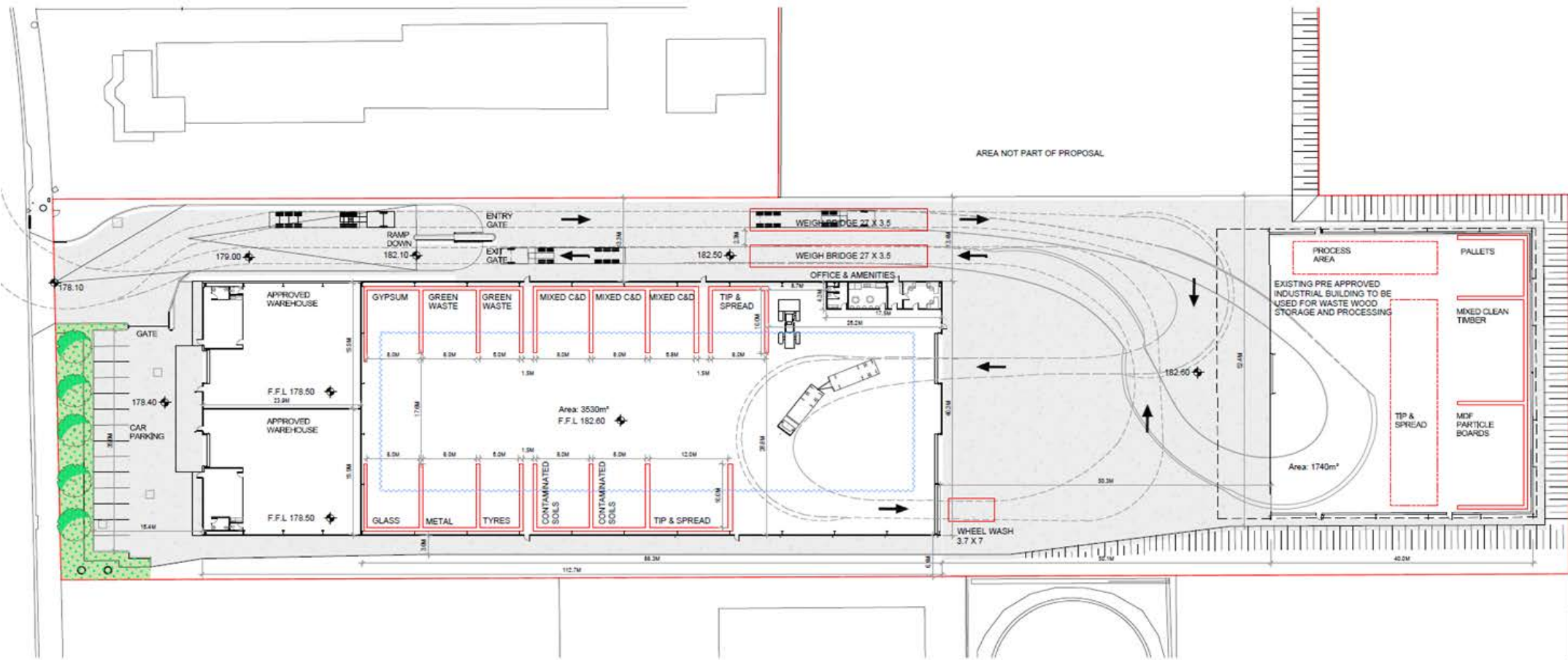

Accepted Material

Waste Type	Waste Composition (% by weight)	Annual Weight (tonnes)	Average Daily Weight (tonnes)	Density (tonnes/m ³)	Total Storage Bay Volume (m ³)	Site Capacity (tonnes)
Mixed C&D waste	40%	40,000	108.5	0.83	204	169
Mixed clean timber	15%	15,000	67.8	0.36	204	73
Pallets	4%	4,000	8.1	0.16	140	22
MDF and particle board	2%	2,000	10.8	0.26	191	50
Green Waste	15%	15,000	16.3	0.45	166	74
Metals	5%	5,000	5.4	0.20	217	43
Gypsum	1%	1,000	5.4	0.17	204	35
Glass	1%	1,000	2.7	0.41	204	84
Tyres	4%	4,000	10.8	0.83	140	116
GSW CT1 (Recyclable)	10%	10,000	27.1	0.83	204	169
GSW CT2 (Restricted)	2%	2,000	8.1	0.83	204	169
TOTAL	100	99,000	271	-	2,078	1,005

The following material will not be accepted at the site:

- Special Wastes (including Asbestos)
- Hazardous Wastes
- General Solid Wastes (Putrescible)

Permissibility

The Somersby Resource Recovery Facility can be defined as a waste or resource management facility which has the meaning of any of the following:

- (a) a resource recovery facility,*
- (b) a waste disposal facility,*
- (c) a waste or resource transfer station,*
- (d) a building or place that is a combination of any of the things referred to in paragraphs (a)–(c).*

A resource recovery facility is described under the definitions of the Gosford LEP as:

“... a building or place used for the recovery of resources from waste, including works or activities such as separating and sorting, processing or treating the waste, composting, temporary storage, transfer or sale of recovered resources, energy generation from gases and water treatment, but not including re-manufacture or disposal of the material by landfill or incineration.”

Under the Gosford LEP, resource recovery facilities are not expressly defined as ‘permitted with consent’ or ‘Prohibited’. However, any other development not specified as ‘permitted without consent’ or ‘prohibited’ is considered ‘permitted with consent’.

The proposal is also permissible under SEPP Infrastructure.



1300 300 641

info@spaceurban.com.au

spaceurban.com.au